

CRYSTALAUDIO

R1

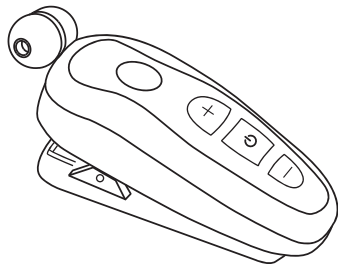

Retractable Earphone



DECLARATION OF CONFORMITY

Radio equipment and telecommunications terminal equipment, Directive 2014/53/EU

Crystal Audio hereby declares that the product, R1 Wireless earphone, is in conformity with provisions of the Directive 2014/53/EU.
The complete text of the Declaration of conformity can be found on the following webpage: www.CrystalAudio.com



User Manual

Charge it

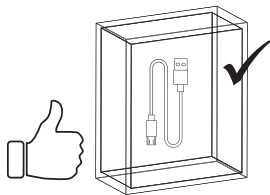

- Use the micro USB cable which is **included** in the package.
- A different micro USB cable might not charge **correctly (or even not at all)** the battery of the headphones.

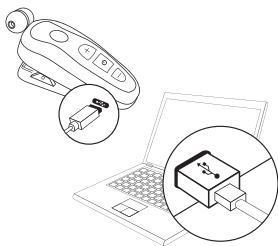

Connect:

- the **micro USB plug** into the headphone's port.
- the **USB plug** into any compatible USB device.



A full charge of the battery takes approximately **2 hours**.

! The headphones are automatically deactivated during charging process.

- While battery is **charging** the indication light is **red**.

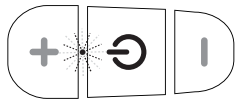

- When battery has been **fully charged** the light turns **blue**.

Connect it

1

- Long press (3") the middle button to **activate** (or deactivate) the headphones.

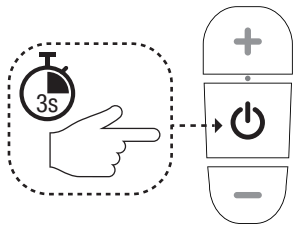

2

- Once turned on, the headphones enter automatically **Pairing mode**.
- The indication light is flashing **red-blue, alternately**.

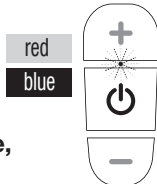

3

- **Activate** Bluetooth mode on your Bluetooth enabled device.
- **Search** for available devices and select **CRYSTAL AUDIO R1**.



- In order to pair a second device wirelessly you have to deactivate the Bluetooth mode on your first device and then repeat all necessary steps as stated above to pair the second device.
- The headphones will be automatically turned off if they are not connected to a device within 5 minutes.

Use it



Music

Press to:
Automatically
retract the cord

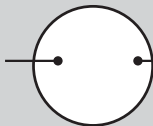

Press to:
Automatically
retract the cord



Calls

Short press:
Increase Volume
Long press (3sec.):
Next track



Short press:
Increase Volume

Short press:
Play/Pause
Long press (3sec.):
Turn On/Off



Short press: Answer/End Call
Long press (3sec.): Reject Call
Double click: Redial last outgoing call

Short press:
Decrease Volume
Long press (3sec.):
Previous track



Short press:
Decrease Volume

Overview

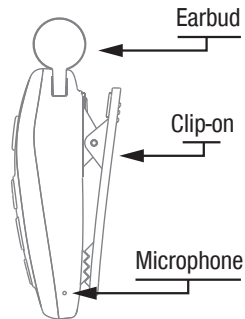
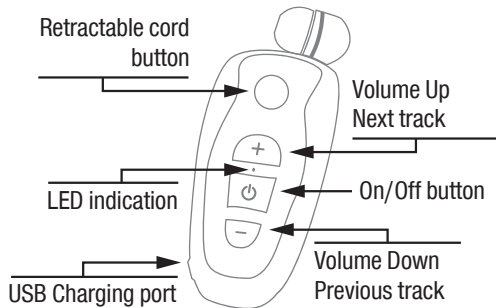

User
Manual



Micro USB
cable

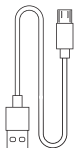

2nd Earbud
2x Ear-tips

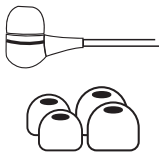

Lanyard
30cm



WARRANTY

The product comes with a 1-year warranty starting from the purchase date. Warranty is valid only with the original proof of purchase (receipt or invoice). This warranty covers only the repair or replacement of the device and it is effective only in Greece.

Technical Specifications

Drivers:	10mm
Impedance:	32Ω
Bluetooth Version / Range:	v4.1 / up to 10m
Battery Type:	LiPo
Charge Time:	1.5-2 hours
Playback/Talk Time:	9-11 hours
Stand by Time:	≈ 240 hours
Dimensions:	59x26x24mm
Weight:	19g

WARNING

- Using the headphones at a high volume for an extended period might lead to hearing damage.
- This product is not a toy. Keep out of reach of children.
- This product is not waterproof. It should be kept away from any kind of liquids and places of extreme humidity, rain, snow etc.
- Low battery may lead to "Poor" or "Lost" Bluetooth connection.
- Do not overcharge the battery of the device.
- Avoid exposing the product to excessive heat sources such as fire, candles, radiators, direct sunlight etc.
- This product should not be treated as household waste. Please hand over to the applicable collection point for the recycling of electronic equipment.

Designed in Europe by Crystal Audio.

Assembled in China with the highest quality standards.

The Bluetooth® word mark and logos are registered trademarks owned by Bluetooth SIG Inc. and any use of such marks by Crystal Audio is under license.



www.CrystalAudio.com